

## ADDENDUM No. 3: October 04, 2017

PROJECT: EAST JEFFERSON GENERAL HOSPITAL  
CARDIAC CATHETERIZATION LAB C RENOVATION  
4200 HOUMA BLVD.  
METAIRIE, LOUISIANA 70006

PROJECT NO.: STBA 41197.31

FROM: SIZELER THOMPSON BROWN ARCHITECTS  
HEALTHCARE DESIGN GROUP, LLC  
300 Lafayette Street, Suite 200  
New Orleans, Louisiana 70130  
(504) 523-6472

TO: All Bidders

This Addendum forms a part of the Contract Documents and modifies the original Bidding Documents dated **September 13, 2017**. The contents of this Addendum shall be included in the Contract Documents when the Agreement is executed. Changes made by this Addendum take precedence of the Documents of earlier date. Bidders are advised to call attention of all sub-bidders and suppliers to changes, which may affect their work.

Acknowledge receipt of this Addendum in the space provided on the Bid Form.

### BIDDER INFORMATION

1. The bid date has been changed to **October 17, 2017**. Sealed bids will be received until the hour of 2:00 p.m., c.s.t. by East Jefferson General Hospital in the Purchasing Department, 4200 Houma Boulevard, Metairie, LA 70006 and starting at 2:30 p.m., c.s.t. all bids will be publicly opened and read.

### BIDDER QUESTIONS

2. Please confirm there are no alternates for this project.  
*There are no alternates for this project.*
3. Will RFIs be allowed after the visitation of the lab itself on 10/5?  
*Yes, RFI's will be accepted until one week prior to the new bid date (10/9/17) at 2 p.m., c.s.t.*
4. The specs 12 24 13 Part 2.3 call for two different type of fabric 5300 series at 5% openness and 200 series Blackout, I can't find on the drawings which windows will receive 5300 or 200?  
Please clarify.  
*Blinds will be dual with both UV and blackout.*
5. On drawing A801 note 9 call for room darkening window shade in room 202. I believe this window will be with 200 series blackout fabric, but because the window is very long the shade will be split in half, to eliminate the gap light in between we can use the side and sill channels,

please advise.  
*See answer above*

6. The shades will be installed in pockets or with fascia?  
*With fascia*
7. Is this to be standard business hours construction?  
*This will be standard business hours construction, however other hours are available subject to coordination with owner. Any noisy activity should be scheduled during off hours.*
8. Is there a freight elevator near the lab location?  
*Please see attached sketch for elevator location.*
9. Has the area been checked for asbestos and lead?  
*The hospital has a lead and asbestos evaluation on file. Lead nor asbestos are known to be in this area of work.*
10. Please confirm the ceiling heights for the areas of work.  
*Please see sheet A601 for ceiling heights in all areas.*
11. Will there be dedicated contractor parking and laydown areas?  
*See attached Sketch of laydown area and parking*

#### **MODIFICATIONS TO THE DRAWINGS**

##### **DRAWING SHEET D102**

12. Delete note #12 temporary dust partition between the Cath Lab C 202 and the Control Room 203.
13. Change the material for doors 201 and 113D to S.C. Wood.

##### **THIS ADDENDUM CONSISTS OF:**

2 TYPEWRITTEN ADDENDUM PAGES  
2 ATTACHMENTS COMPRISED OF 1 SHEET  
For a total of 4 DOCUMENT SHEETS.

**1 SITE PLAN**  
**ASK-01** 1 : 1450

- CRANE LOCATION (IF NEEDED)
- STAGING CONTRACTOR TO MODIFY WOOD FENCING TO PROVIDE GATE AS NECESSARY FOR ACCESS TO STAGING AREA.
- DUMPSTER
- SINGLE TRUCK PARKING
- CONTRACTOR'S TRAILER

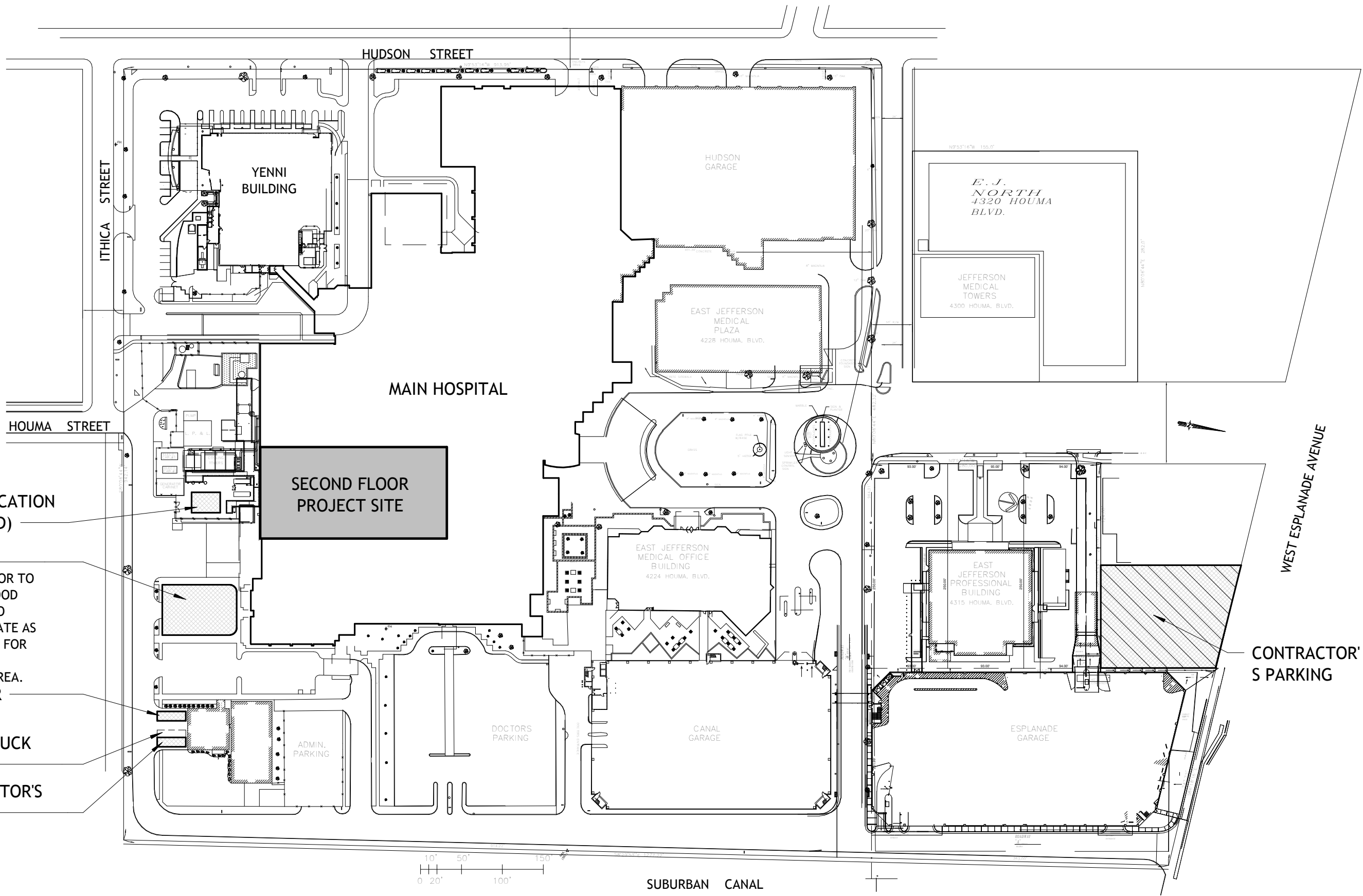

project no.	date	drawing number
41197.31	10/04/17	ASK-01
file name	issued for	this drawing modifies:
.rvt	ADDENDUM 03	Unnamed

sketch description
EJGH- CARDIAC CATHETERIZATION LAB C RENOVATION 4200 HOUMA BLVD. Unnamed

**SIZELER THOMPSON BROWN ARCHITECTS**  
**HEALTHCARE DESIGN GROUP, LLC.**  
 300 LAFAYETTE STREET, SUITE 200  
 NEW ORLEANS, LOUISIANA 70130  
 (504) 523-6472 FAX (504) 529-1181

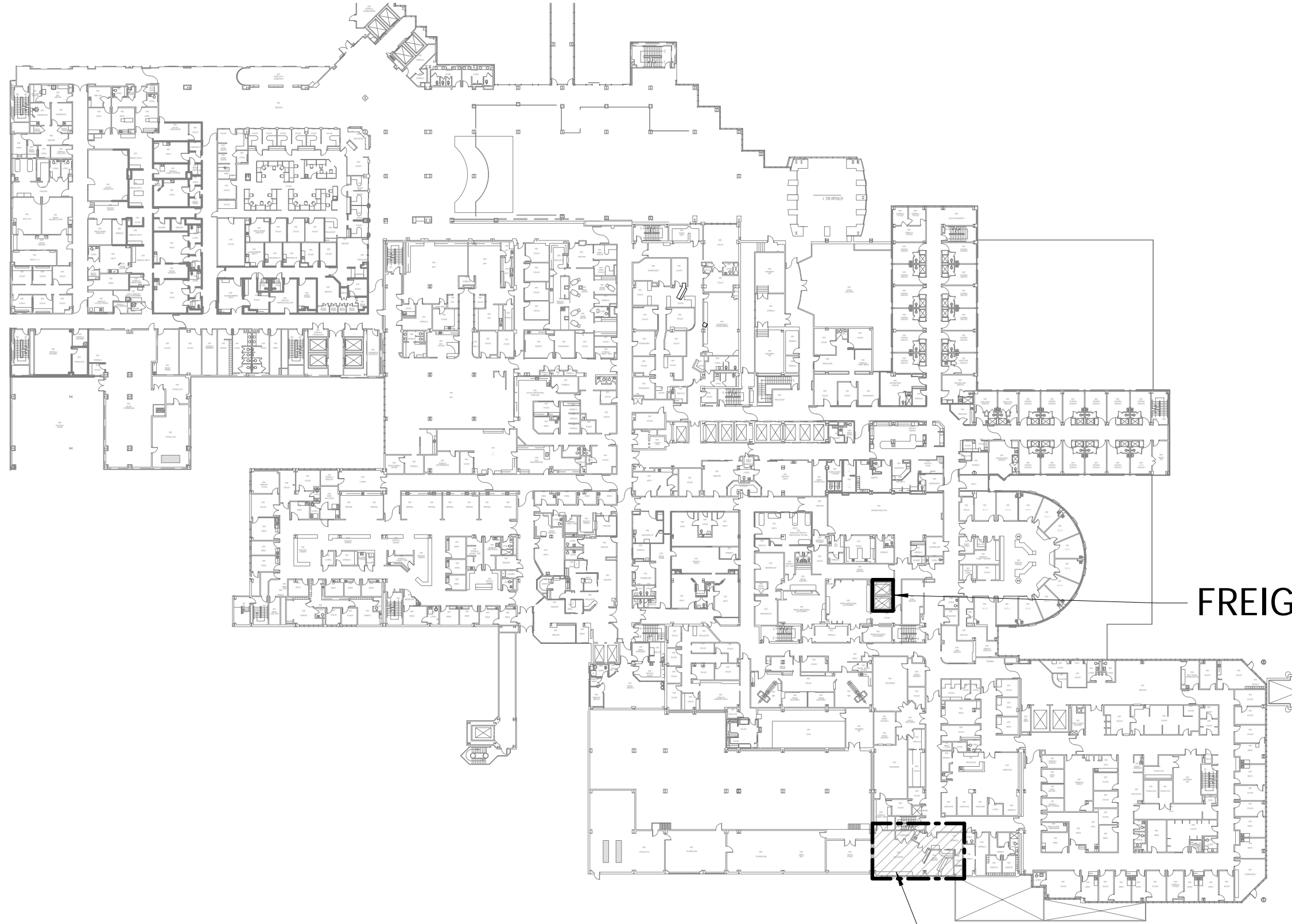

FREIGHT ELEVATOR

AREA OF WORK

1 SECOND FLOOR LOCATION PLAN ASK-02  
 ASK-02 1" = 60'-0"

**SIZER THOMPSON BROWN ARCHITECTS**  
 HEALTHCARE DESIGN GROUP, LLC.  
 300 LAFAYETTE STREET, SUITE 200  
 NEW ORLEANS, LOUISIANA 70130  
 (504) 523-6472 FAX (504) 529-1181

sketch description  
**EJGH- CARDIAC CATHETERIZATION  
 LAB C RENOVATION**  
 4200 HOUMA BLVD.  
 Unnamed

project no. 41197.31	date 10/04/17	drawing number <b>ASK-02</b>
file name .rvt	issued for ADDENDUM 03	this drawing modifies: Unnamed